

NPCATRAVEL



The Travel Program of the National Parks Conservation Association

NOV. 6-10, 2021

Wild California Escape:

CHANNEL ISLANDS NATIONAL PARK

EXPERIENCE ISLANDS SO STUNNING THEY WERE FIRST PROTECTED AS A NATIONAL MONUMENT IN 1938.

TAKE A HIKE

TO ONE OF ONLY TWO NATURALLY OCCURRING TORREY PINE GROVES IN THE WORLD.

CATCH A GLIMPSE

OF THE ELUSIVE FOX SPECIES ONLY FOUND IN THE CHANNEL ISLANDS

SEA LIONS PLAYING
Channel Islands
National Park



HIGHLIGHTS

- Kayak, stand-up paddleboard, hike, or relax ashore and enjoy the wild and remote island landscapes
- See the last major light station to be built on the west coast on the striking Anacapa Island
- Spot some of the 150 native plant and animal species found nowhere else in the world
- Learn how NPCA has worked to protect Channel Islands National Park from external threats



On the National Park Service ferry to Isle Royale National Park

Wild California Escape (Small Ship Cruise):

Channel Islands National Park

 **Activity level: Easy to Moderate**

AVAILABLE DATES: November 6-10, 2021 | Max: 100

5 days/4 nights | NPCA Member Price: From \$3,200 per person

Deposit: \$750 per person

Arrive/Depart: Los Angeles, California

Reservations: Please contact Jared Dial, NPCA's Travel Program Manager, at 1.800.628.7275 or email the Travel Program at travel@npca.org.

Inclusions: Four nights accommodations aboard ship; all meals and nonalcoholic beverages aboard ship; shore excursions; sightseeing and entrance fees; special access permits and park fees; use of kayaks and paddleboards; taxes and service charges; and services of the Lindblad Expeditions' natural history staff.

Exclusions: Air transportation; transfers from airport upon arrival or departure; passport or visa fees, if necessary; meals not indicated; travel protection plan; optional diving excursions; personal items such as Wi-Fi, laundry, spa treatments, alcohol, etc.; and gratuities to the ship's crew, which are at your discretion.

Known by some as North America's Galápagos, the Channel Islands and their surrounding waters provide habitat for more than 2,000 species of plants and animals, including 150 species found nowhere else in the world. These islands are so significant that they were first protected as a national monument in 1938 and later became a national park in 1980. Get away for a revitalizing experience of wildness and wellness. Travel aboard the National Geographic Venture, your floating base camp, and sail to this picturesque destination. We'll actively explore three of the five wildlife-rich islands which make up the Channel Islands National Park, plus beautiful nearby Catalina Island. On this exhilarating voyage, you'll hike in a rare grove of Torrey pines, paddle through impressive sea caves, and marvel at architectural gems, all the while having the ability to set your own pace for recreation or relaxation in this unmarred landscape. All activities are facilitated by naturalist guides and other experts, including an NPCA staff host who will give in-depth information on NPCA's important role in the history of the park. You'll discover how NPCA helped to remove ranching and hunting operations on Santa Rosa Island, allowing native species to flourish and providing the public with unhindered access to this beautifully isolated place.

ITINERARY

DAY Los Angeles / Embark

1 Embark on the *National Geographic Venture* in the early evening — where you'll meet the team and settle in for the days ahead! *(D)*

DAY Anacapa and Santa Cruz Islands, Channel Islands National Park

2 Wake to the gentle motion of the ship at anchor off the rocky outcropping of East Anacapa Island. Join your fitness instructor on the sun deck for morning yoga before heeding the call of the breakfast buffet. After breakfast, join naturalists aboard our expedition landing craft to go ashore on East Anacapa. Enjoy a scenic hike to **Inspiration Point** to soak in the views, take photos of **Anacapa Lighthouse**, built in 1912, and the last major light station to be built on the West Coast. Or, for a more relaxing option, explore **Arch Rock** via Zodiac, a rugged yet comfortable small watercraft that can land almost anywhere. *(B,L,D)*



Anacapa Lighthouse,
Channel Islands
National Park

DAY 3 Santa Rosa Island, Channel Islands National Park

Kick-start your morning with a stretch class before breakfast. Weather permitting, go kayaking, hike one of the many trails, or simply relax ashore enjoying the bird life or watching for the small, endemic Channel Island fox. Join our naturalists for a more strenuous hike out to the base of the island's **Torrey pines**, one of the world's rarest pines, and one of only two naturally occurring groves in the world. End the day with a sunset cocktail party. *(B, L, D)*

DAY 4 Santa Catalina Island

Spend the day discovering the colorful history and natural wonders of **Santa Catalina Island**. Once a haunt of smugglers and gold-diggers, the island was transformed into a resort destination by chewing gum tycoon William Wrigley Jr. in the 1920s. Some 50 years later, heirs Philip K. Wrigley and Dorothy Wrigley Offield established the **Catalina Island Conservancy**, protecting nearly 90% of the island.

After a morning workout on deck followed by breakfast, enjoy a brief introduction by a conservancy member to learn about their work on the island before heading out on the trail for spectacular views of the coastline and the Catalina backcountry. With luck, we may catch a glimpse—or a photo—of the bison herd who have resided on Santa Catalina Island since 1924. Head for the water to kayak or stand-up paddleboard. After lunch, the ship arrives in **Avalon Harbor**, where you'll have time to explore on your own. Explore downtown Avalon, the island's only incorporated city, with a

NPCA has a long history of protecting Channel Islands National Park ecosystem from privatization and commercial exploitation.

population a little under 5,000. Take the 30-minute (mostly uphill) stroll up **Avalon Canyon** to visit the **Wrigley Monument** and **The Botanic Garden**. Or visit an architectural gem: the famous **Catalina Casino**, built by William Wrigley Jr. in 1929. Scuba certified? Our team can arrange diving and gear rental for you with a top local operator. Return to the ship for a farewell dinner and a last evening at sea under the stars. *(B, L, D)*



DAY 5 Los Angeles / Disembark

Awake dockside in the bustling Port of Los Angeles (early risers can catch the action in one of the world's largest ports). Enjoy a final breakfast on board before disembarking—refreshed by your getaway. *(B)*



Travel Insurance: To protect yourself from the loss of deposit and cancellation fees, you are encouraged to purchase travel insurance. If you need assistance, NPCA recommends contacting Travel Insurance Services; confirmation packets will include details.

Traveler Responsibility: Travelers are responsible for choosing an NPCA trip consistent with their ability, fitness, and overall health. All travelers are required to complete and return their registration form, personal information form, flight form, and waiver before being allowed to participate in a trip. Travelers also are responsible for reading and understanding all pre-departure materials and bringing the appropriate clothing and gear as suggested.

Pricing

CAT. 1	CAT. 2	CAT. 3	CAT. 4	CAT. 5 Suite	CAT. 1 Solo	CAT. 2 Solo
\$3,200	\$3,890	\$4,500	\$4,990	\$5,590	\$4,780	\$5,850

Trip Cancellation Policy: Cancellation notice must be submitted in writing and is effective upon date of receipt.

Until 120 days prior to trip start	119-90 days prior	89-30 days prior	59-45 days prior	44 days prior
Deposit is 100% refundable less \$350 per person admin fee	Refund less \$750 per person	Refund less 25% of trip cost per person	Refund less 50% of trip cost per person	No refund

Cabins: All cabins face outside with windows or portholes, private facilities and climate controls. Category 4 cabins have step-out balconies.

Public Areas: Global gallery; fitness center; LEXspa; lounge with full service bar and facilities for films and presentations; observation deck; mud room with lockers for expedition gear, and a partially covered sundeck with chairs and tables. Our “open bridge” provides guests an opportunity to meet our officers and captain and learn about navigation.

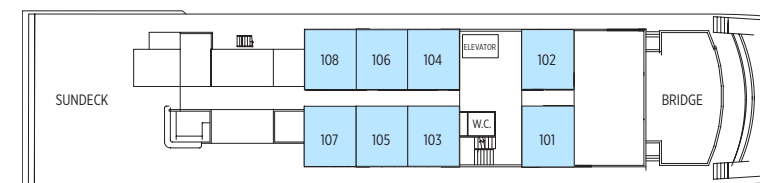

OBSERVATION DECK

CATEGORY 5: Observation Deck #101-108 Cabins feature two lower single beds that can convert to a Queen, large view windows, an expanded bathroom, writing desk, ample storage space, and a convertible sofa bed to accommodate a third person.

NOTE: Sole Occupancy cabins are available in Categories 1 and 2 only. Third person rates are available in Category 5 cabins at one half the double occupancy rate.

Connecting Cabins via internal doorway access:
Main Deck: #312-314, #311-315, #306-308, #305-307 Upper Deck: #224-226, #225-227

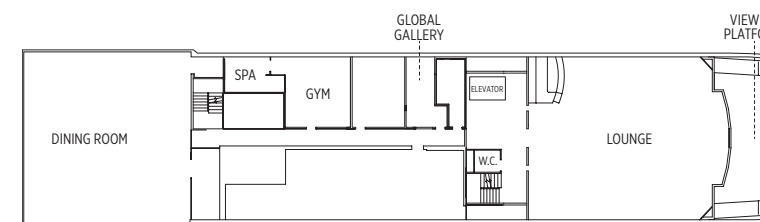

LOUNGE DECK

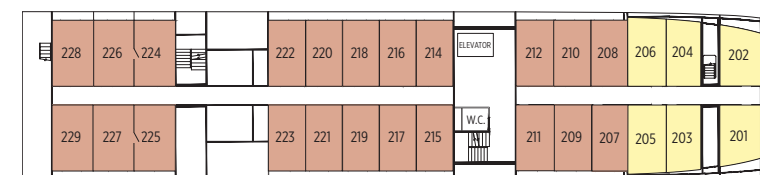

UPPER DECK

CATEGORY 3: Upper Deck #201-206 Cabins feature two lower single beds that can convert to a Queen, a writing desk and two large view windows.

CATEGORY 4: Upper Deck #207-229 Cabins feature two lower single beds that can convert to a Queen, a writing desk, large view window and small, private balcony.



MAIN DECK

CATEGORY 1: Main Deck #301-306 Cabins feature two lower single beds that can convert to a Queen, a writing desk and two portholes.

CATEGORY 2: Main Deck #307-315 Cabins feature two lower single beds that can convert to a Queen, a writing desk and two portholes.

COVID19 SAFETY PROTOCOLS

NPCA is always committed to providing high quality tours that ensure the well-being and safety of our members and supporters. Each of our travel partners have developed robust safety protocols to protect the health of our guests, staff, and the communities we visit. As conditions and guidelines continue to evolve, our travel partners are committed to easing concerns and creating flexible options for those interested in rescheduling or booking new travel. NPCA advises all individuals to follow the guidance of public health experts at the Centers for Disease Control and the World Health Organization in protecting themselves and their communities from the coronavirus. Specific guidelines such as health screenings and social distancing will be determined based on the trip's date of departure and group size. Please contact us for details.



Why Travel with NPCA?

SAFETY AND FLEXIBILITY

Your health and safety is our top priority. NPCA has worked with each of our travel partners to develop safety measures for our 2021 trips in response to the global pandemic.

EXPERT TRIP LEADERS

Every trip will be led by an NPCA staff expert and naturalist guide. We are teaming up with experienced tour operators to give you exclusive insights into your national parks.

SMALL-SIZED GROUPS

Group size on each of our land trips is limited to no more than 16 people to maximize your interactions with experts, enhance wildlife viewing and boost educational opportunities throughout your experience.

CONVENIENT TRAVEL

Everything is included in your tour, including meals, accommodations, snacks, interpretive guides, special speakers, transportation within the destination and all activities (unless otherwise stated).

ENVIRONMENTALLY CONSCIOUS

NPCA partners with tour operators that support cultural and natural heritage, maximize the economic benefits in the destinations we operate in and establish guidelines for managing environmental impacts.

EXCELLENT VALUE

Our tours offer members the opportunity to explore the parks without the hassle of planning or the frustrations of crowds. We handle the logistics, so you don't have to.

NPCA EXCLUSIVE COLLECTION

Starting in 2021, we will offer a handful of unique tours designed to give you exclusive experiences within the parks and special behind-the-scenes access to National Park Service staff, NPCA partners, and other local specialists. Our goal is to offer NPCA members the best itineraries in adventure and educational travel in the places we know best: America's national parks. Our custom-designed itineraries highlight NPCA's important contributions to park protection while delivering outstanding interpretive hikes and sight-seeing in national parks around the country.

NPCA is the only independent, nonpartisan organization dedicated to advocacy on behalf of the National Park System. We are 100% privately funded and we rely on donations from individuals like you. One traveler per group must be an active NPCA member to participate in an NPCA trip. An annual membership starts at \$15 per person. Please make dues payable to NPCA by check or credit card at npca.org.