

NPCATRAVEL



The Travel Program of the National Parks Conservation Association

NOV. 4-8, 2023

Wild California Escape:
Channel Islands
NATIONAL PARK

EXPERIENCE ISLANDS SO
STUNNING THEY WERE FIRST
PROTECTED AS A NATIONAL
MONUMENT IN 1938

TAKE A HIKE TO ONE OF
ONLY TWO NATURALLY
OCCURRING TORREY PINE
GROVES IN THE WORLD

CATCH A GLIMPSE
OF THE ELUSIVE FOX
SPECIES ONLY FOUND IN
THE CHANNEL ISLANDS

Santa Cruz Island. Part of the Channel Islands, CA



HIGHLIGHTS

- Kayak, stand-up paddleboard, hike or relax ashore and enjoy the wild and remote island landscapes
- See the last major light station to be built on the West Coast on the striking Anacapa Island
- Spot some of the 150 native plant and animal species found nowhere else in the world
- Learn how NPCA works to protect Channel Islands National Park from external threats



Anacapa Lighthouse,
Channel Islands National Park

Wild California Escape: Channel Islands National Park

(Small Ship Cruise with Lindblad Expeditions)

AVAILABLE DATES: November 4–8, 2023

Length of Tour: 5 days/4 nights

NPCA Member Price: From \$3,360 per person | **Deposit:** \$750 per person

Arrive/Depart: Los Angeles, California

Reservations: Please contact Jared Dial, Associate Director, Educational Travel Program, at 1.800.628.7275 or email the Travel Program at travel@npca.org.

Bring the Kids: Sharing an expedition with your kids or grandkids is a life-enhancing experience – so take \$500 off the double occupancy price for travelers under 18.

Ship: *National Geographic Venture* (100 guests in 50 spacious outside cabins)

Inclusions: All accommodations aboard ship; all meals and non-alcoholic beverages aboard ship; transfers to and from the hospitality room to the ship; shore excursions and sightseeing; use of kayaks and paddleboards; the expedition leader, naturalist staff and expert guides; all port charges and service taxes; and gratuities to local guides.

Exclusions: Airfare; REAL ID, passport and visa expenses if necessary; travel protection plan; optional diving excursions; meals not indicated on itinerary; discretionary gratuities to ship's crew; alcoholic beverages, items of a personal nature and voyage chronicle.

ACTIVITY LEVEL

Easy to Moderate



Known by some as North America's Galápagos, the Channel Islands and their surrounding waters provide habitat for more than 2,000 species of plants and animals, including 150 species found nowhere else in the world. These islands are so significant that they were first protected as a national monument in 1938 and later became a national park in 1980.

Embark on an unprecedented five-day expedition into wildness and wellness in the remote and remarkable Channel Islands. Step aboard in Los Angeles and sail to three of the five wildlife-rich islands that make up Channel Islands National Park, plus Catalina Island. Dayboats can take you to a single island to hike or camp, but a true in-depth exploration of the Channel Islands on our nimble ship (with comfortable cabins) is a

unique offering and the only way to take in the full natural splendor of this extraordinary national park. It is akin to a safari camp in Africa—comfortable, in the heart of things, yet mobile. Everything you want is aboard—paddleboards, kayaks and Zodiacs; a welcoming crew; naturalists; a wellness specialist; and a certified photo instructor. You'll actively explore rugged landscapes, revel in pure nature, and rejuvenate mind, body and soul.

Your NPCA staff host will provide in-depth information on NPCA's important role in the history of the park, including how NPCA helped to remove ranching and hunting operations on Santa Rosa Island, allowing native species to flourish and providing the public with unhindered access to this beautifully isolated place.



Santa Catalina Island

ITINERARY

DAY NOV 4: Los Angeles / Embark

1 Arrive in Los Angeles or toss your bag in your car if you live there and meet us at our hospitality room to check-in by 3:00 PM and later transfer to the ship to be welcomed aboard. Familiarize yourself with the ship, stow your stuff and take in the sights on the ship's deck. We'll embark in the early evening—where you'll meet the team and settle in for the days ahead! *(D)*

DAY NOV 5: Anacapa and Santa Cruz Islands, Channel Islands National Park

2 Wake to the ship at anchor off the rocky outcropping of **East Anacapa Island**. Join your fitness instructor on the sundeck for morning yoga before heeding the call of the breakfast buffet. After breakfast, join naturalists aboard our Zodiacs (rigid inflatable boats) to go ashore on East Anacapa. The goal is the **Anacapa Island Lighthouse**, built in 1932, the last major light station to be built on the West Coast. Soak in the views from **Inspiration Point** or, for a more relaxing option, explore **Arch Rock** via Zodiac. *(B, L, D)*

DAY NOV 6: Santa Rosa Island, Channel Islands National Park

3 Kick-start your morning with a stretch class before breakfast. Weather permitting, go kayaking, hike one of the many trails or simply relax ashore. With luck, we may catch a glimpse—or photo—of the

elusive **fox species endemic to the island**. Join the naturalists for a more strenuous hike out to the base of the **Torrey Pines State Natural Reserve**, which contains what is considered one of the world's rarest pines and is one of only two naturally occurring groves in the world. End the day with a sunset cocktail party. *(B, L, D)*



Santa Rosa Island Fox

NPCA has a long history of protecting the Channel Islands National Park ecosystem from privatization and commercial exploitation.

DAY NOV 7: Santa Catalina Island

4 Spend the day discovering the colorful history and natural wonders of **Catalina Island**. Once a haunt of smugglers and gold-diggers, the island was transformed into a resort destination by chewing gum tycoon William Wrigley, Jr. in the 1920s. Some 50 years later, William's heirs, Philip K. Wrigley and Dorothy Wrigley Offield, established the **Catalina Island Conservancy**, protecting nearly ninety percent of the island. After a morning workout on deck followed by breakfast, meet a conservancy member to learn about their work on the island before heading out on the trail for spectacular views of the coastline and the **Catalina backcountry**. With luck, catch a glimpse of the **elusive bison herd** that has resided on Catalina Island since 1924. Head for the water to kayak or stand-up paddleboard. After lunch, the ship arrives in **Avalon Harbor** for a free-ranging afternoon on your own. Explore downtown Avalon, the island's only incorporated city, population a little under 5,000. Take the 30-minute (mostly uphill) stroll up Avalon Canyon to visit the **Wrigley Memorial and Botanical Gardens**. Or visit an architectural gem: the famous **Catalina Casino**, built by William Wrigley, Jr. in 1929.

*Scuba-certified? Our team will arrange diving and gear rental for you with a top local operator. Return to the ship for a farewell dinner and a last evening at sea under the stars. *(B, L, D)**

DAY NOV 8: Los Angeles / Disembark

5 Awake dockside in the bustling Port of Los Angeles (early risers can catch the action in one of the world's largest ports). Enjoy a final breakfast on board before disembarking and either transferring to the airport or heading to your car or Uber—refreshed by your getaway. *(B)*

Please note: *This itinerary is subject to change based on weather conditions, the order of the National Park permit allocations and Park sanctioned construction projects on the islands.*



Lindblad Hike, Channel Islands National Park

Pricing: Pricing varies by Cabin Category type (refer to Deck plan for layout)

CAT. 1	CAT. 2	CAT. 3	CAT. 4	CAT. 5 Suite	CAT. 1 Solo	CAT. 2 Solo
\$3,360	\$4,090	\$4,730	\$5,240	\$5,870	\$5,030	\$6,150

Final Payment: Payment is due 90 days prior to departure. Lindblad Expeditions reserves the right to cancel your reservation if payment has not been received by final payment due date.

Trip Cancellation Policy: Cancellation notice must be submitted in writing and is effective upon date of receipt.

Until 120 days prior to departure	119-90 days prior	August 6, 2023	89-60 days prior	59-45 days prior	44 days prior
Deposit is refundable minus \$350 per person fee	Deposit cost is non-refundable	Final payment due	25% of trip cost is non-refundable	50% of trip cost is non-refundable	No refund

Travel Insurance: To protect yourself from the loss of deposit and cancellation fees, you are encouraged to purchase travel insurance. If you need assistance, NPCA recommends contacting Travel Insurance Services through USI Affinity at 1-800-937-1387 or at <http://my.travelinsure.com/npca>; email confirmation packets will include additional details.

Activity Level: Our trips are appropriate for people in good health with overall good mobility. Travelers should be comfortable participating in up to three hours of physical activity per day, which includes walking or standing for extended periods (sometimes on uneven terrain) and climbing stairs. Daily activities on this cruise are always offered in different levels - slow paced, moderate and faster paced hikes. Any physical conditions requiring special attention, diet, or treatment should be reported when booking to determine what accommodations can be made.

Traveler Responsibility: Travelers are responsible for choosing an NPCA trip consistent with their ability, fitness and overall health. All travelers are required to complete and return their NPCA waiver of liability, personal information form, flight form and accept Lindblad Expeditions' Terms and Conditions before being allowed to participate in a trip. Travelers are also responsible for reading and understanding all pre-departure materials and bringing appropriate clothing and gear.

Entry And Visa Requirements: Guests are advised to verify travel documents (REAL ID/passport/ transit visa/entry visa) for the country through which they are transiting and/or entering. Reliable

and most current information regarding international travel can be found by contacting the consulate/ embassy of the country(s) you are visiting or transiting through. We will not be responsible if you are denied entry or transit into a country, if you are unable to provide valid documents as per the country's requirement.

Smoking And Vaping Policy: Allowed only in designated outdoor areas.

Other Terms & Conditions: Certain other provisions concerning, among other things, limitations of Lindblad Expeditions' and the National Geographic Expeditions' (a division of National Geographic Partners, LLC) liability for loss of property, injury, illness or death during the voyage will be provided to all guests on the ship's ticket sent prior to departure or upon request. By registering for a trip, the guest agrees to all such terms and conditions.

Note: Itinerary and prices listed in this brochure are as of publication date and are subject to change. Under normal conditions the total expedition price is guaranteed at the time of booking. However, the expedition pricing is determined far in advance of initial departure on the basis of then-existing projections of fuel and other costs. In the event of increases in those costs, including but not limited to increases in the price of fuel, currency fluctuations, increases in government taxes or levies, or increased security costs, the right is reserved to adjust the price of your expedition or add a surcharge to cover such unexpected increases. We will always provide an explanation of the reason for increase in costs.



Ship Details: National Geographic Venture

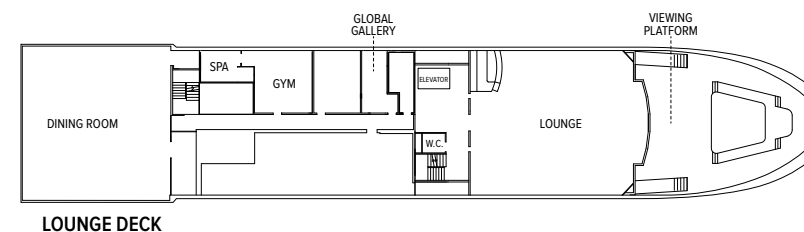
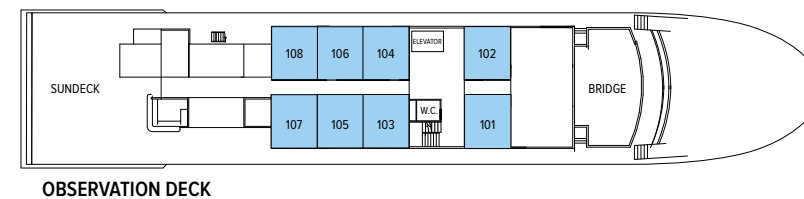

CATEGORY 1: Main Deck #301-306 Cabins feature two lower single beds that can convert to a Queen, a writing desk and two portholes.

CATEGORY 2: Main Deck #307-315 Cabins feature two lower single beds that can convert to a Queen, a writing desk and two portholes.

CATEGORY 3: Upper Deck #201-206 Cabins feature two lower single beds that can convert to a Queen, a writing desk and two large view windows.

CATEGORY 4: Upper Deck #207-229 Cabins feature two lower single beds that can convert to a Queen, a writing desk, large view window and small, private balcony.

CATEGORY 5: Observation Deck #101-108 Cabins feature two lower single beds that can convert to a Queen, large view windows, an expanded bathroom, writing desk, ample storage space and a convertible sofa bed to accommodate a third person.

NOTE: Sole Occupancy cabins are available in Categories 1 and 2 only. Third person rates are available in Category 5 cabins at one half the double occupancy rate.

Connecting Cabins via internal doorway access:
Main Deck: #312-314, #311-315, #306-308, #305-307 Upper Deck: #224-226, #225-227

COVID-19 SAFETY PROTOCOLS

Each of our travel partners have developed robust safety protocols to protect the health of our guests, staff and the communities we visit. **At this time, proof of vaccination is required to participate in this trip.** All tour staff and partners associated with the trip, including drivers, guides, NPCA staff and speakers will be fully vaccinated.

[Click here for up-to-date protocols for this trip.](#) Please contact us for details.



Why Travel with NPCA & Lindblad Expeditions?

NPCA has partnered with Lindblad Expeditions for over ten years. We partner with Lindblad because of their commitment to educational travel, sustainability and for our shared commitment to protecting national park lands. Lindblad Expeditions has been a leader in small-ship expedition travel since 1966 when Lars-Eric Lindblad brought the first non-scientific travelers to Antarctica.

IMMERSIVE TRAVEL

For over 50 years, Lindblad Expeditions has led the way in expedition travel. Their small, nimble ships and onboard experts change the way you see the world through one-of-a-kind, immersive, and educational experiences that bring you closer to nature than ever before.

TRAVEL WITH EASE

Take the burden off yourself and let us plan the details for you. All you need to do is show up and we will help you create memories that last for a lifetime.

TRAVEL FOR GOOD

By booking this trip with us, a small portion of your trip cost supports NPCA's mission to protect the parks for present and future generations. Plus, as a 100% carbon-neutral company and a commitment to conservation and sustainability, traveling with Lindblad Expeditions means traveling for good.

LEARN FROM THE BEST

Lindblad's team of naturalists add perspective and personality to your experience. In addition, you will be joined by at least one NPCA expert who will give unique insights into our park protection work in the Channel Islands and around the country.

BUILD CONNECTIONS

In addition to connecting with new cultures and incredible landscapes, you will form lasting relationships with other park enthusiasts who also appreciate the importance of discovery in travel.

SAFETY AND FLEXIBILITY

Your health and safety is our top priority. Lindblad Expeditions' extensive safety protocols can be [viewed here](#).

NPCA is the only independent, nonpartisan organization dedicated to advocacy on behalf of the National Park System. We are 100% privately funded and we rely on donations from individuals like you. One traveler per group must be an active NPCA member to participate in an NPCA trip. An annual membership starts at \$15 per person. Please make dues payable to NPCA by check or credit card at [npca.org](https://www.npca.org)